

BIO-CHANNEL® STAR



THE TOUGHEST SYSTEM....
JUST GOT A LITTLE TOUGHER



INTRODUCING the New & Improved BIO-CHANNEL STAR, the latest innovation by Robbins that now meets ALL performance standards **WORLDWIDE!**



Robbins has redefined uniformity & performance by improving the Bio-Channel Star system to pass ALL global performance standards worldwide, including the stringent MFMA 3rd party certification, PUR, which is strongly governed by the MFMA. PUR was designed utilizing exacting testing methodologies, to ensure that customers receive a reliable, well performing, competitive sports surface. Bio-Channel Star is great for new construction and renovation facilities!

NEW & IMPROVED BIO-CHANNEL STAR System Benefits:

- Improved shock absorption & ball bounce for improved player performance
- Continuous subfloor and continuous resilient pad provides vibration damping/control & uniformity for improved comfort
- Anchored subfloor interwoven design is perfect for heavy loads & allows lateral movement to reduce stress, maintaining structural integrity
- Computer-assisted manufacturing technology for quality assurance

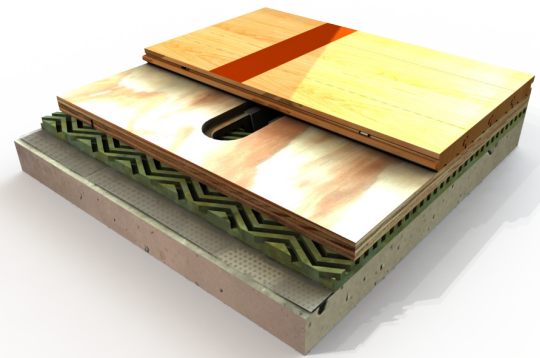

robbinsfloor.com | 1.800.543.1913

Robbins, Inc. | 4777 Eastern Avenue | Cincinnati, OH 45226

MAPLE FLOORING SYSTEMS

Product Specifications

System Type	Anchored Resilient Panel
Slab Depression	2 1/8" (54mm) with 25/32" (20mm) maple 2 3/8" (60mm) with 33/32" (26mm) maple
Surface- MFMA Northern Hard Maple	Robbins Continuous Strip® XL (FJ)
Exceeds ALL Industry Standards:	MFMA PUR DIN 18032 part 2 2001 DIN 18032 part 2 1991 ASTM F2772-09 FIBA Level 1 EN 14904 Type 4
Anchorage	Anchor Spike with Metal Channel
Subfloor Construction	Nominal 3/4" x 24" x 96" subfloor sheathing that has factory prepared anchor slots
Resilience Layer	9/16" Profiled Zero/G® Shock Pad
Vapor Barrier	6 MIL Polyethylene
Optional Construction	Contact a Robbins Representative for Alternative Systems
LEED Contributions	MR credit 4, 5, & 7 IEQ 4.1, 4.2, 4.3, 4.4 FSC® Lumber Available *Credits are based on products selected and location of facility



Wall View

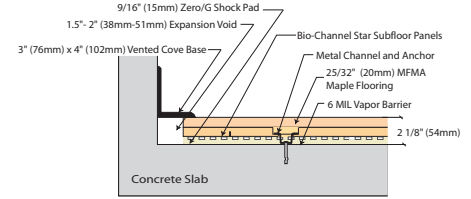

Threshold View

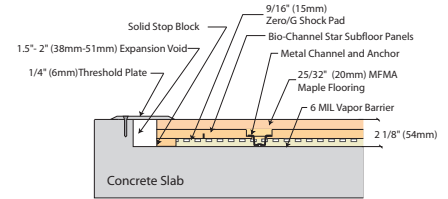

Equipment View

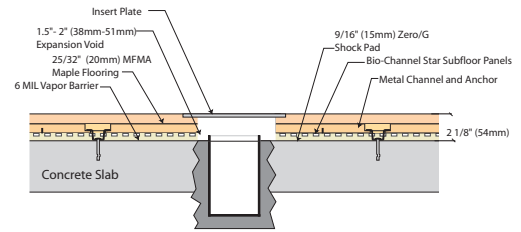

Bio-Channel Star Reference Facilities

- Comite Olimpico- Chile
- SMU Practice Facility
- Cleveland State University
- Davenport University
- Ball State University
- Alcorn State University

