

A SPORTS FLOOR GOOD FOR THE ENVIRONMENT & THE ATHLETE

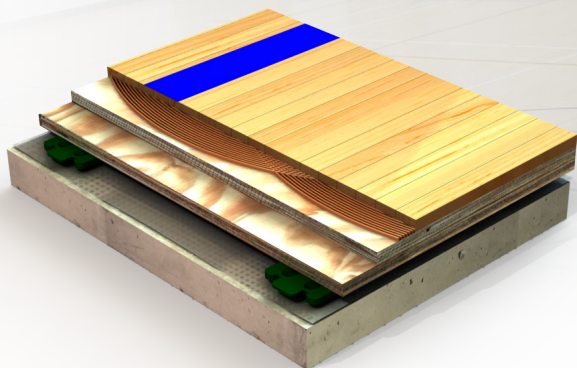

You expect a lot from your athletic floor. **DURABILITY. ATTRACTIVENESS. COMFORT** and **SAFETY**. And you know better than to think that, when it comes to floor coverings, “one size fits all.” So does Robbins. That’s why Sportwood Ultra Star is the perfect floor for you – no matter what you require.

Sportwood Ultra Star is solidly constructed of beautiful MFMA PQ edge-grain northern hard maple and features an adaptable, “tunable” underlayment.

Elastomeric urethane adhesive bonds the maple Sportwood to layers of stabilizing load-distribution subfloor, sitting atop a matrix of our EPDM rubber Bio-Pads or alternate resilient element. These pads can be adjusted, or “tuned,” to your desired level of shock absorption – making Sportwood Ultra Star ideal for any number of activities. Whether you need shock absorption security for aerobic, basketball or other sports, or simply want a comfortable multi-use surface for cafeteriums or other facilities, simply specify the amount of resiliency needed, and Robbins will take care of the rest. The load-distribution subfloor, plus the resilient shock-pads, allows Sportwood Ultra-Star floors more “give” – meaning less chance of foot, leg or back injury. In addition to this safety feature, Sportwood Ultra Star is the most dimensionally stable maple product on the market, able to withstand even extreme moisture conditions.



- *The traditional appearance of Sportwood is constructed with genuine, edge-grain cut, Northern Hardwood Maple, a long preferred surface in many basketball, volleyball and other indoor sport facilities*
- *Sportwood is an environmentally friendly product that is comprised of off-fall hardwood materials*

robbinsfloor.com | 1.800.543.1913

Robbins, Inc. | 4777 Eastern Avenue | Cincinnati, OH 45226

Product Specifications

System Type	Floating Parquet Panel
Slab Depression	1 3/4" (44mm) with 7/16" (11mm) maple and 7/16" (11mm) pad 2" (51mm) with 7/16" (11mm) maple and 3/4" (19mm) pad
Surface- MFMA Northern Hard Maple	7/16" (11mm) or 5/16" (8mm) thick maple parquet flooring
Environmental Impact	 Sportwood is an environmentally friendly product comprised of off-fall hardwood materials
Subfloor Construction	2 layers of nominal 1/2" or 7/16" x 48" x 96" (12mm x 1219mm x 2438mm) exposure 1,rated subfloor sheathing
Resilience Layer	Many pad options available
Vapor Barrier	6 MIL Polyethylene
Optional Construction	Contact a Robbins Representative for Alternative Systems
LEED Contributions	MR credit 4, 5, & 7 IEQ 4.1, 4.2, 4.3, 4.4 FSC® Lumber Available <i>*Credits are based on products selected and location of facility</i>
Warranty	1 year Industry Standard with optional Extended Warranty Program (<i>Egis Floorlife</i>)

Wall View

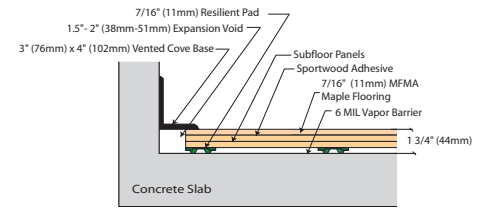

Threshold View

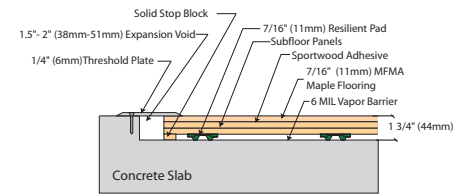

Equipment View

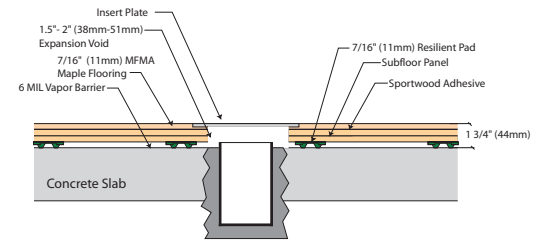

Sportwood Ultra Star Reference Facilities

- Auburn Student Wellness
- Airdrie Recreation Centre
- University of Alaska
- Copley High School
- Wichita State University
- Simon Fraser University
- Olivet College
- East Kentwood High School
- Lakeland High School
- Milford High School

robbinsfloor.com | 1.800.543.1913